

Tucson Model #8720

B-Vent Gas Stove Heater

Exploded Parts Drawing, Revision 0.5
(from Serial #005049)

Production Dates: January 1998 -
Serial#: 001001 -

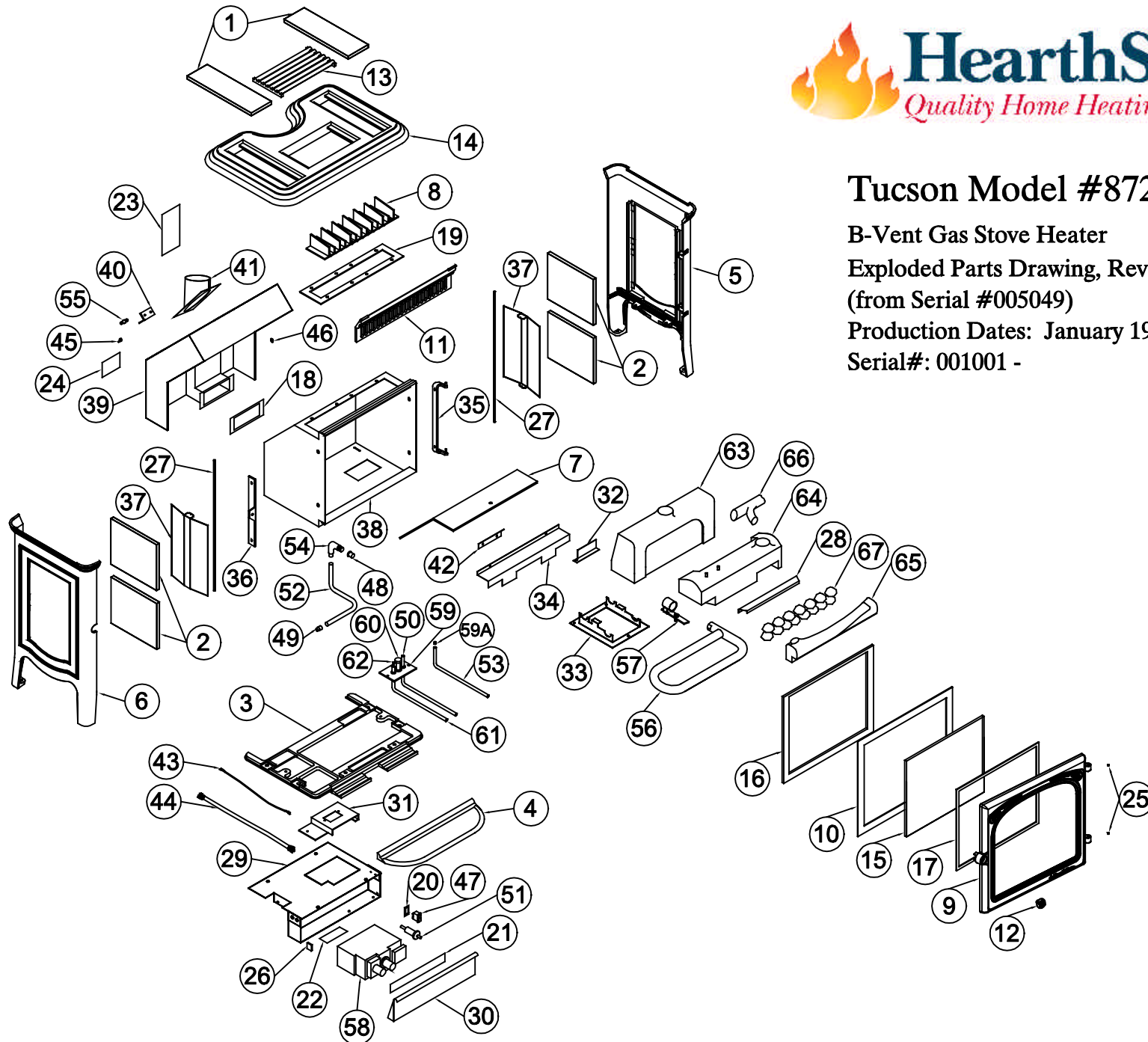



Model: Tucson B-Vent #8720

Production Dates: January 1998 -

Serial #: 001001 -

[Link to Parts Pricelist](#)

Note: Color must be specified for cast iron parts which are available in enamel.

Key	Part #	Description	
1	1741-350	Top Stone 3 5/16" x 10 5/16"	Must specify stone color
2	1741-351	Side Stone 7 1/2" x 6 1/2"	Must specify stone color
3	2710-116	Bottom Casting	
4	2710-220	Ashlip	
5	2710-321	Right Side Casting	
6	2710-326	Left Side casting	
7	2710-480	Firebox Baffle - Cast	
8	2710-486	Heat Exchanger	
9	2710-511	Door	
10	2710-560	Glass Retainer Frame	
11	2710-581	Front Grill	
12	2710-655	Door Handle	
13	2710-810	Top Grill Plate	
14	2710-815	Top Casting	
15	3030-027	Glass 13 1/4" x 1/8" x 5mm	
16	3110-057	3/8" Gasket	
17	3160-080	Gasket Tape 3/4" x 1/16"	
18	3160-148	5 3/4" x 3 1/4" Firebox/Draft Hood Gasket	
19	3160-150	Gasket: Heat Exchanger	
20	3300-334	Label: On/Off/T-Stat	
21	3300-502	Lighting Instruction Label	
22	3300-506	Installation Warning Label	
23	3300-507	Safety Rating Label	
24	3300-510	Fuel Conversion Label	
25	4700-0605	Hinge Cap Plugs 3/16" ID x 11/16" OD	
26	4700-0795	Access Door Magnet	
27	5210-3070	Threaded Rod 1/4-20 x 19"	
28	5320-070	Ember Support Screen Serial #<005302	
29	5710-121	Valve & Ignitor Bracket	
30	5710-128	Access Door	
31	5710-132	Pilot Bracket	
32	5710-141	Pilot Shield	
33	5710-152	Burner Tube Holder Serial #<005302	
	5320-072	Burner Tube Holder Serial #>005302	
34	5710-160	Air Intake Flap	
35	5710-170	Hinge Bracket	
36	5710-180	Latch Bracket	

37	5710-470	Stone Clip
38	5710-513	Firebox
39	5710-550	Draft Hood
40	5710-555	Spill Switch Bracket
41	5710-680	Exit Collar
42	5710-594	Baffle Chip
43	7000-018	Hi-Temp Wire
44	7000-032	On/Off/T-Stat Wire Harness
45	7000-121	3/16" Loop Strap for Spill Switch
46	7000-122	Insulating Bushing for Spill Switch
47	7000-200	On/Off/T-Stat Switch
48	7200-240	Burner Orifice NG #40
	7200-253	Burner Orifice LP #53
49	7210-007	Fitting 3/8" NPT x 3/8" Compression
50	7210-090	Thermopile
51	7210-103	Piezo Igniter
52	7211-005	3/8" Manifold Supply Tube
53	7211-009	Pilot Tube w/fittings
54	7211-020	90 degree elbow 1/8"NPT x 3/8"CMP
55	7211-026	Spill Switch
56	7211-226	Burner Tube Serial # < 004882
	7211-229	Burner Tube Serial #004882 - 005302
	97-80200	Burner Tube Serial # > 005302
		Includes:
	4400-0200	(4)1/8" x1/8" Blind Rivets
	5320-075	Left Ember Screen
	5320-077	Right Ember Screen
	7211-233	"S" Burner Tube
57	7211-231	Air Shutter Serial #>005302
58	7211-310	SIT Valve NG 50% Turn Down (superceeded by 7211-320)
59	7211-370	3-Way Top Convertible Pilot Assy. NG 52mm
59A	7211-131	Screw In Pilot Orifice LP #30mm
60	7211-390	Pilot Hood - 3 way - Top Convertible
61	7211-430	Ceramic Electrode
62	7211-470	Thermocouple
63	7211-554	Rear Log Serial #<005302
64	7211-555	Middle Log Serial #<005302
65	7211-556	Front Log Serial #<005302
66	7211-557	Top Log Serial #<005302
67	7211-558	Ceramic Embers

93-81200 Burner/Log Upgrade Kit Serial #'s between 004882 - 005302
Includes:
93-66200 Log Set
97-80200 Burner Tube
5320-072 Burner Tube Holder Serial #>005302
93-66200 Log Set Serial #>005302
Includes:
7211-560 Main Log
7211-561 Twig
7211-558 Ceramic Embers
90-56920 Wall Thermostat Kit
Includes:
7000-015 40' 18/2 Thermostat Wire
7200-506 Millivolt Wall Thermostat
93-56200 NG Conversion Kit Top Convertible Serial #>004556
Includes:
7200-240 #40 NG Burner Orifice
7211-163 .62mm NG Pilot Orifice
7211-312 NG Regulator 50% Turn Down
93-56906 NG Conversion Kit Serial #<004556
Includes:
7200-240 #40 NG Burner Orifice
7211-151 .51mm NG Pilot Orifice (Drop Down)
7211-312 NG Regulator 50% Turn Down
93-56201 LP Conversion Kit Top Convertible Serial #>004556
Includes:
7200-253 #53 LP Burner Orifice
7211-131 .30mm LP Pilot Orifice
7211-313 LP Regulator 50% Turn Down
93-56907 LP Conversion Kit Serial #<004556
Includes:
7200-253 #53 LP Burner Orifice
7211-130 .30mm LP Pilot Orifice (Drop Down)
7211-313 LP Regulator 50% Turn Down