



Technical Data Sheet

Tucson I DV 8701, Tucson II DV 8702, Stowe I DV 8321 & Stowe II DV 8322 Restrictor Plate and Stove Adaptor Kit Installation

KIT #'S 97-65020 & 97-60924HB

(Included with your Tucson/Stowe Direct Vent Stove)

Publish date: 12/3/2003

KIT COMPONENTS:

97-65020

- (1) #5950-922 Restrictor Plate
- (1) #3160-155 4" X 6" Gasket Ring
- (1) #4500-0062 #10 X 3/8" Sheet metal Screw

97-60924HB

- (Bag) #4500-0073 16 - #8 X 3/8" Screws
- (1) #5701-0924HB 4" X 6-5/8" Stove Adaptor
- (1) #3160-155 4" X 6" Gasket
- (1) #3160-157 6-1/2" X 9-5/16" Gasket

TOOLS REQUIRED:

Cross-tip Screwdriver

BEFORE YOU BEGIN: Determine if a Restrictor Plate is Required!

To determine if a Restrictor Plate is necessary, refer to the venting section of the owner's manual that is packed with the stove. If a Restrictor Plate is needed, select and fix it in the proper setting, then follow the following instructions. If it is not required, start these instructions with step # 2a.

PROCEDURE:

- 1) A 4" X 6" gasket ring is required on both sides of the Restrictor Plate. Position the 4" X 6" gasket ring and the Restrictor Plate on the inner collar of the stove. Install the Restrictor Plate with the hole divider up at a 12 o'clock position and with the adjustment screw facing into the fire box. This will allow for future adjustments if necessary.

HINT: Use Spray 'n Glue or liquid gasket glue to help hold the gasket rings in place during assembly.

- 2) Position a second 4"X6" gasket ring on top of the Restrictor Plate and install the 4" inner collar on top of the gasket rings and Restrictor Plate. Secure the assembly with 8 of the top screws provided with the stove adaptor kit. Go to step # 3.
 - a) Install the inner stove adaptor and 4" X 6" gasket ring. Secure the assembly with 8 of the screws provided.
- 3) Install the 6-5/8" outer stove adaptor and 6-1/2" X 9-5/16" gasket ring with the remaining 8 screws.
- 4) To adjust the restrictor plate after it has been installed, carefully remove the ember strip and log set. The baffle can now be removed by removing the one retaining screw in the top center of the baffle. To adjust the restrictor plate, remove the adjustment screw and make the necessary adjustments. Replace the baffle, log set and ember strip.

VERTICAL VENTING TERMINATION USING (2) 90° ELBOWS

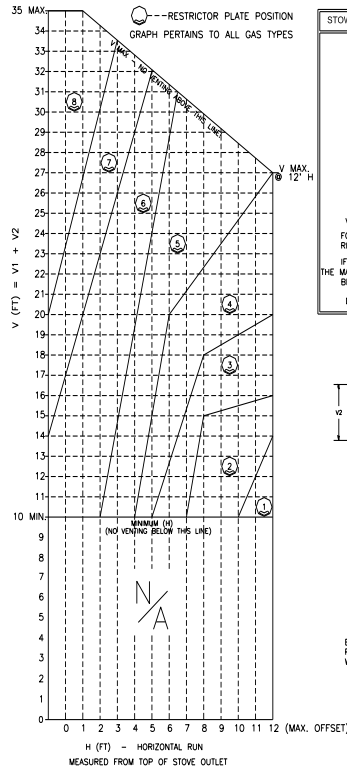

STOVE: VERTICAL VENTING USING (2) 90° ELBOWS

V (FT)	H (FT)
10' MIN. -----	12' MAX.
11' -----	26' MAX.
27' -----	12' MAX.
28' -----	10'-6" MAX.
29' -----	9'-3" MAX.
30' -----	8' MAX.
31' -----	6'-6" MAX.
32' -----	5' MAX.
33' -----	3'-8" MAX.
34' -----	2'-3" MAX.
35' -----	1' MAX.

V MIN. = 10'
V₁ + V₂ = V (FT)
V + H = MAXIMUM ALLOWABLE VENT LENGTH.
FOR CORRECT DRAFT, HORIZONTAL VENTING MUST
RISE 1/4" - 1/2" PER FOOT OF RUN.
IF MORE THAN TWO 90° ELBOWS ARE REQUIRED,
THE MAXIMUM ALLOWABLE HORIZONTAL VENT LENGTH MUST
BE REDUCED BY 5' FOR EACH ADDITIONAL ELBOW.
DO NOT INCLUDE STARTER ELBOW AS AN ELBOW.

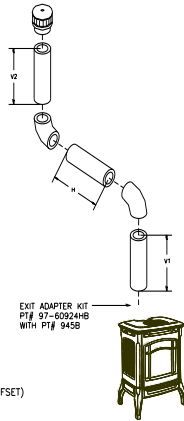

STOVE: VERTICAL FLUE USING:
-A CHIMNEY AS AIR INLET ADAPTER
-A CO-LINEAR ADAPTER

V (FT)	H (FT)
10' MIN. -----	1.5' MAX.
35' MAX. -----	1.5' MAX.

$$H_1 + H_2 = H \text{ (FT)}$$

V + H = MAXIMUM ALLOWABLE FLUE LENGTH

FOR CORRECT DRAFT, HORIZONTAL FLUE MUST
RISE 1/4" - 1/2" PER FOOT OF RUN.

DO NOT INCLUDE STARTER ELBOW AS AN ELBOW.
RESTRICTOR PLATE IN POSITION (1) FULLY OPEN

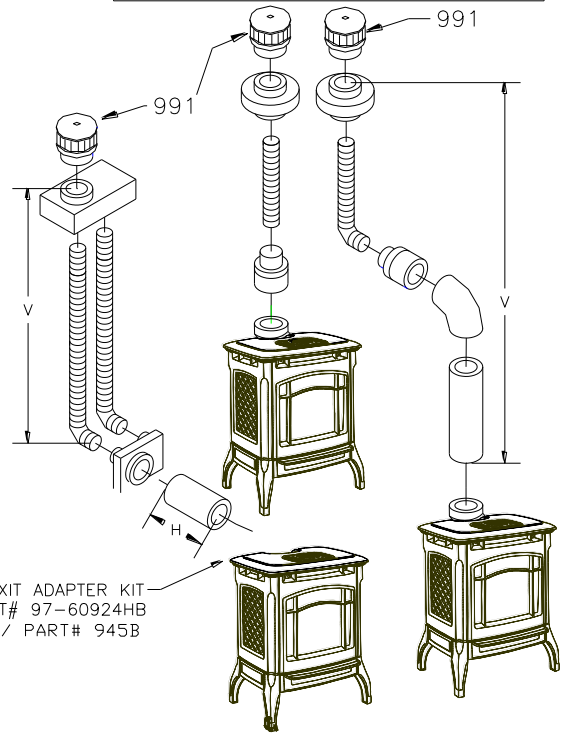

STOVE: HORIZONTAL VENTING USING (1) 90° ELBOW OR (1) 90° ELBOW & (1) 45° ELBOW OR SNORKEL VENTING

V (FT)	H (FT)
9" MIN.	1'-2" MAX.
1'	3' MAX.
2'	10' MAX.
3'-10'	14' MAX.
11' MAX.	14' MAX.

$H1 + H2 = H$ (FT)

$V + H =$ MAXIMUM ALLOWABLE VENT LENGTH.

FOR CORRECT DRAFT, HORIZONTAL VENTING MUST RISE 1/4"-1/2" PER FOOT OF RUN.

DO NOT INCLUDE STARTER ELBOW AS AN ELBOW.

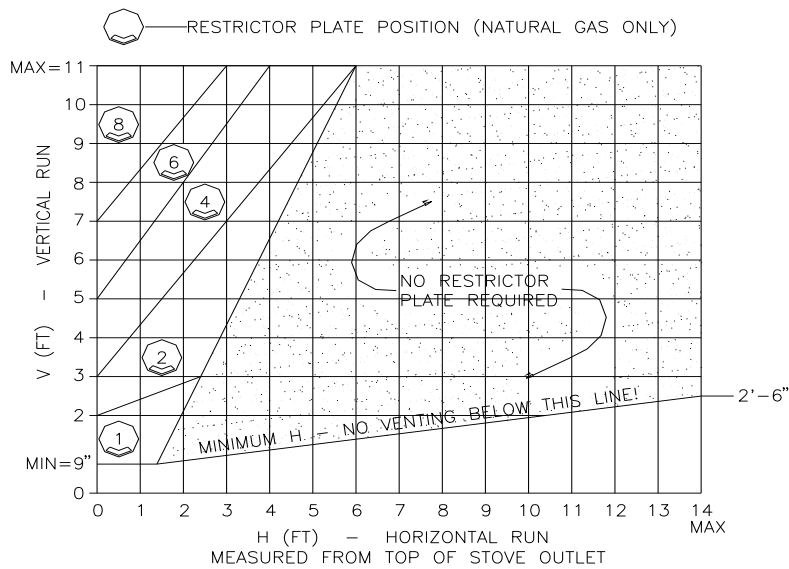

THE NUMBER IN THE CIRCLE SHOWS THE RESTRICTOR PLATE POSITIONS AND ALLOWABLE VENT TERMINATION LOCATIONS. (NO RESTRICTOR PLATE REQUIRED FOR LP GAS)

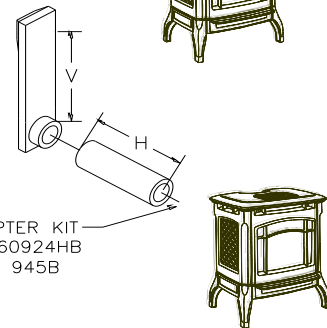
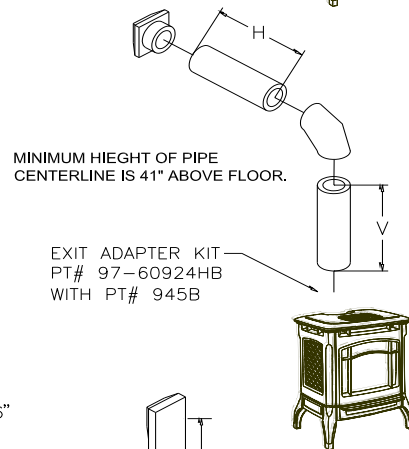
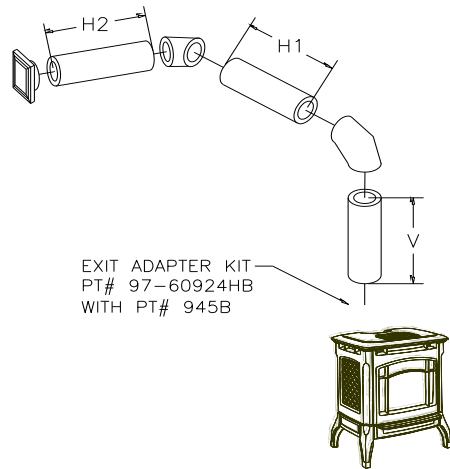

**STOWE: VERTICAL VENTING USING
CO-AXIAL ADAPTER**

V (FT)

H (FT)

10' MIN.— — — 1.5' MAX.

35' MAX.— — — 1.5' MAX.

$$H1 + H2 = H \text{ (FT)}$$

V + H = MAXIMUM ALLOWABLE VENT LENGTH

FOR CORRECT DRAFT, HORIZONTAL VENTING MUST
RISE 1/4"–1/2" PER FOOT OF RUN.

DO NOT INCLUDE STARTER ELBOW AS AN ELBOW.
RESTRICTOR PLATE IN POSITION (1) FULLY OPEN

