



TECHNICAL DATA SHEET

Converting the Champlain Direct-Vent 8300 (ser 1001 to 2065) & Santa Fe 8760 From Natural Gas to LP **KIT #93-56901**

Page: 1 of 3

TOOLS REQUIRED

Phillips Screwdriver
Slotted Screwdriver
10mm Open End Wrench
1/2" Deep Socket or Wrench
3" Socket Extension (optional) Instructions

KIT COMPONENTS

1-#7211-313 LP Valve Conversion Kit
1-#49 Burner Orifice
1-#30 Pilot Orifice
LP Sticker (Red)

CAUTION: *The gas supply must be shut off prior to making this conversion. If the stove is equipped with the optional blower, disconnect it from the electrical source before making this conversion.*

WARNING

This conversion kit must be installed by a qualified gas service agency in accordance with the manufacturer's instructions and all applicable codes and requirements of the authority having jurisdiction. If the information in these instructions is not followed exactly, a fire, explosion, or production of carbon monoxide may result causing property damage, personal injury, or loss of life. The qualified service agency performing this work assumes responsibility for the proper conversion of this appliance with this kit.

CAUTION: The gas supply must be shut off prior to making this conversion. If the stove is equipped with the optional blower, disconnect it from the electrical source before making this conversion.

PROCEDURE:

1. To gain access to the firebox, remove the four screws that hold the front casting (including glass) to the stove. To remove the two bottom screws, open the valve access door (pull down on the ash lip). Care should be taken as the screws are removed not to chip the enamel or drop the front casting.

Page: 2 of 3

HearthStone Quality Home Heating Products
317 Stafford Ave., Morrisville, VT 05661
www.hearthstonestoves.com

M:\Customer Service\Tech Data Sheets\Archive\TDS93-56900 Champlain DV 8300 (ser 1001 to 2065) Santa Fe DV 8760 NG to LP Conversion Kit.doc



2. Carefully remove the log set, embers, ember screen, and the burner tube. Make a note of their positions for re-assembly.
3. Locate the air plenum (the steel piece the burner tube passes through) in the firebox and remove it by lifting it straight up and out of the stove.
4. Using a 1/2" deep socket with a 3" extension (or 1/2" wrench), remove the NG gas orifice(#31), located on the inside of the back of the firebox. Install the LP orifice(#49). Important: To prevent damage to the main gas line, hold the elbow which the orifice is attached to when removing and installing the orifices
5. Locate the pilot assembly inside the firebox. Remove the phillips screws that hold the pilot base to the bottom of the firebox. Carefully lift the pilot assembly up into the firebox, high enough to expose the attachments underneath (taking care not to 1. Kink the thermocouple tube, 2. Chafe the thermopile wire, 3. Avoid damage to the gasket between the pilot base and the firebox).
6. Using a #10 metric wrench, remove the nut that holds the flexible pilot line to the pilot base. Tap the top of the pilot assembly until the NG orifice drops out. Place the LP (#30) pilot orifice onto the top of the pilot line and thread it back into the pilot assembly. Tighten with the #10 metric wrench.
7. Push the pilot assembly back down into its original position and secure it with the previously removed screws. Check to make sure the ignitor wire is still connected to the ceramic ignitor. Verify the connection by observing the spark when the ignitor is pressed.
8. Open the air shutter adjustment so that it is in the fully open position. Replace the air plenum, burner tube, logs, ember screen, and embers. Refer to the owner's manual for the proper placement of these pieces if necessary.

NOTE: The remainder of this conversion will be done to the valve. Access to the valve by pulling the ashlip/valve access door down into the open position

VALVE CONVERSION: See illustrations.

9. Using a screwdriver, remove and discard the three pressure regulator mounting screws (A), pressure regulator tower (B) and diaphragm (C).
10. Insure that the rubber gasket (D) is properly positioned and install the new HI/LO pressure regulator assembly to the valve using the new screws (E) supplied with the kit. Tighten screws securely.
11. Install the enclosed identification label (F) to the valve body where it can be easily seen. Place the white NG sticker over the red LP sticker on the valve door.
12. Turn on the gas supply. For checking and properly adjusting the manifold pressure, refer to the appliance owner's manual for instructions. **LEAK TEST BEFORE AND AFTER LIGHTING THE STOVE.**
13. The input rate of the heater can be verified by checking the manifold pressure. If the manifold

HearthStone Quality Home Heating Products
317 Stafford Ave., Morrisville, VT 05661
www.hearthstonestoves.com

M:\Customer Service\Tech Data Sheets\Archive\TDS93-56900 Champlain DV 8300 (ser 1001 to 2065) Santa Fe DV 8760 NG to LP Conversion Kit.doc

pressure is correct, then the input rate is correct. Refer to the appliance owner's manual for the:

- a. Details on adjustment for proper pilot and main burner flame appearance.
- b. Instructions for placing all markings provided in the kit in the appropriate location on the heater.
- c. Instructions for checking out the normal operating sequence of the ignition system.
- d. Location on valve to check manifold pressure.

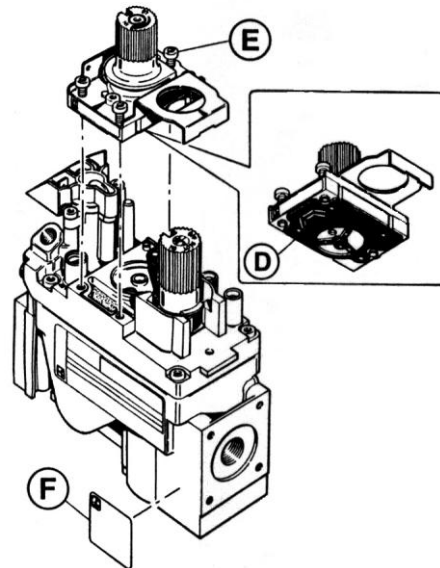
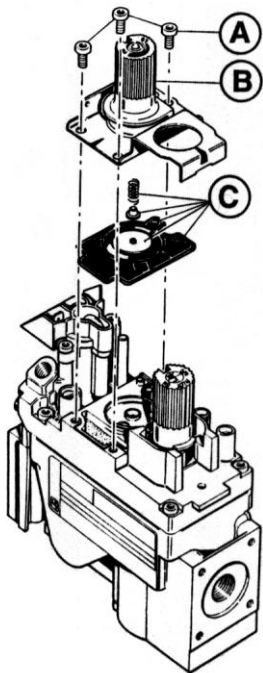

WARNING: Make sure proper replacement orifices have been used.

LP ORIFICES:	Main Burner	0 - 610m	#49 (Standard)
	Pilot #30	610 - 1370m	#50(High Altitude)
NAT. GAS ORIFICES:	Main Burner	0 - 610m	#31 (Standard)
		610 - 1370m	#32 (High Altitude)
	Pilot #51		