

Technical Data Sheet

Installation of the Front Latch on the Phoenix, Mansfield, Homestead, and Heritage 8020 Model Stoves *Assembly #90-73111*

Use on all models of the Phoenix (8610, 8611, & 8612), all Mansfield Models (8010 & 8011), the Homestead (8570), and the Original Heritage (8020)

Date: 10/15/2012

Page: 1 of 2

KIT CONTENTS (90-73111):

- 1 – #5600-025 Shaft & Latch
- 1 – #5010-080 Chrome Crank
- 1 – #5240-140 Spring Ring
- 2 – #4500-2975 Set Screws 5/16" x 1/4"
- 9 – #4700-0790 Brass Latch Spacer Rings

TOOLS REQUIRED:

- 5-32 Allen Wrench

BEFORE YOU BEGIN: Work on a cool stove.

PROCEDURE:

1. Open the door that is being worked on and lift it off the stove. Place it on a workbench or table. When working on an enameled door, protect the enamel by first laying down a sheet of foam or cardboard. Remove the existing latch assembly by removing the setscrew(s) in the latch with the 5-32" allen wrench.

NOTE: When installing the new latch on the Mansfield, Homestead, or Heritage stove model, place 7-9 of the brass spacers on the latch shaft. If you are installing the latch on a Phoenix model stove, place 1 – 2 of the spacers onto the shaft of the latch.

2. Place the new latch shaft through the door with the brass spacers properly placed on the inner portion of the latch. When installing the new latch, the spring ring should be placed over the shaft of the latch on the outer portion of the door. Line the crank up on the shaft so that the setscrews will turn against the flat portions of the shaft. Press the chrome crank onto the shaft so that the spring ring fits into the slot cut out in the bottom of the chrome crank. Press down firmly on the chrome portion of the latch and tighten the setscrews with the allen wrench.

- Place the door back onto the stove and check the fit of the latch. Separating the latch and adjusting the number of brass washers can adjust the fit. To tighten the latch, eliminate a brass washer from the inside of the latch; to loosen the assembly, place an additional washer onto the inside of the latch. If additional washers are needed, the original washers can be reused.

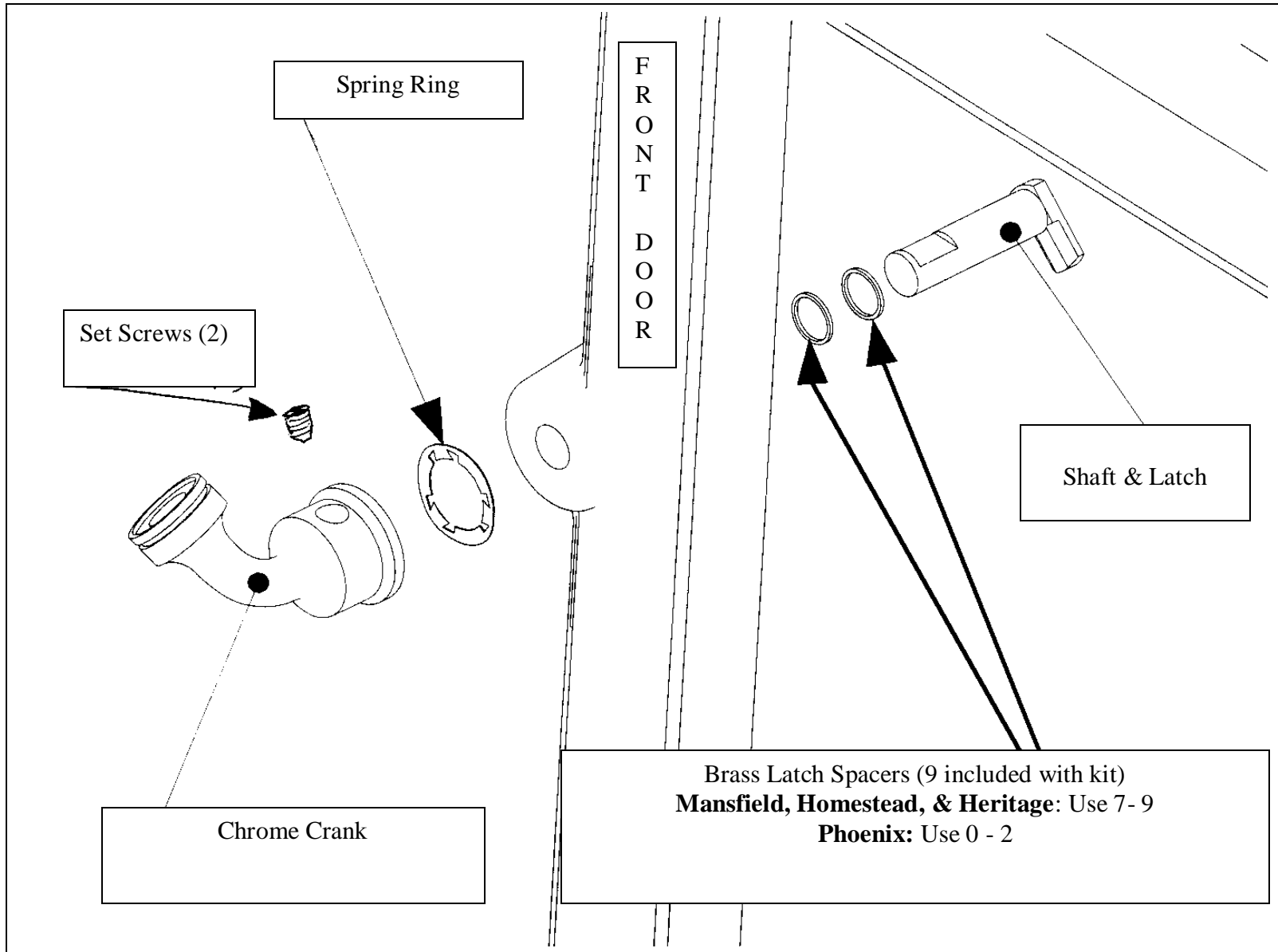

Figure 1 – Parts Illustration

