

Technical Data Sheet

Heritage 8024 Door and Bypass Handle Replacement Instructions

Assembly 90-71240

For front door, side door, and ash pan door handles

INCLUDED IN KIT:

- (1) 3900-175 - Wood Handle
- (1) 4500-1680 - Handle Screw
- (3) 4600-0400 - Split Washer

TOOLS REQUIRED:

Pair of Work Gloves
5/32" Allen Wrench
Pliers or Vise Grips
Slotted Screwdriver

BEFORE YOU BEGIN: *Always work on a cool stove.* Read the instructions thoroughly before starting the repair. Identify all parts included in the kit. Report any shortages to your dealer.

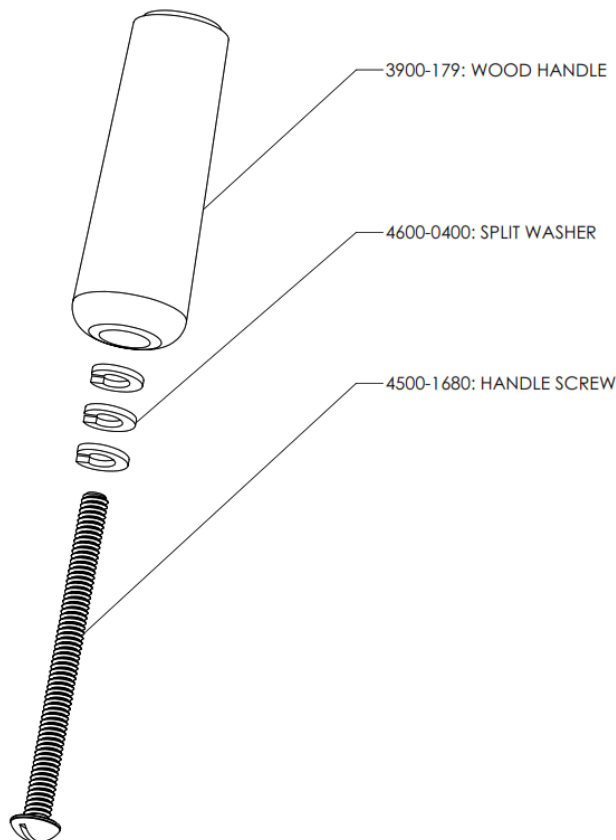

Figure 1: Handle Components

- (1) If old handle is still in place, use the screwdriver turn out the screw that holds the wooden handle to the latch assembly. Discard old handle and fasteners.
- (2) Thread washers and screw through new wooden handle as shown in Figure 1.
- (3) Use screwdriver to tighten screw into cast iron crank on latch assembly.
- (4) If not enough thread is exposed to engage securely, remove split washers to adjust fit.