

Technical Data Sheet

Replacing the Primary Air Linkage Rod on the Equinox

Part Number 5000-133 for the Model 8000

Publish Date: 05/14/2009

Tools Required:

7/16" Wrench or Socket
Hammer

Before You Begin: Work on a cool stove.

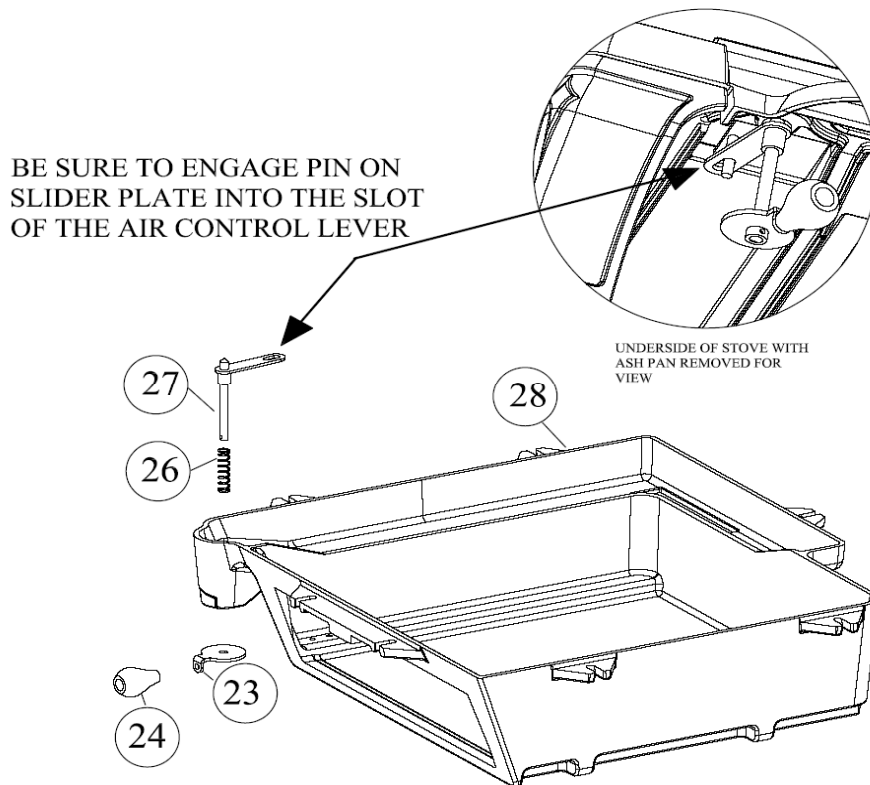

Illustration #1

The Ash Dump & Primary Air Handle Connection

The primary air linkage moves through two holes in the bottom of the stove. As the cast parts expand and contract in response to the heating and cooling of the firebox, the rod may shift very minutely, but enough to cause it to bind on rare occasions. This may cause the air control to move with difficulty, or become stuck. To completely eliminate this as a concern, the linkage rod (item 27 in the page one drawing) has been modified. The exposed portion of the shaft above the connector arm on the top of the linkage has been eliminated. The linkage now passes through a single hole and will not bind, but still has enough support to stay in place and function properly.

To replace the linkage, follow these instructions.

1. Remove the ash pan door by first removing the two bolts located under the ash dump with the 7/16" wrench.
2. With the ash door removed and set aside, place a couple of boards directly under the ash dump. This will protect the hearth and allow you to work on the ash dump.
3. Remove the five bolts that hold the ash dump (28) to the bottom of the stove with a 7/16" wrench or socket. Gently drop the ash dump down onto the boards and pull it out to work on it.
4. Tap out the small roll pin (and retain for reassembly) in the linkage rod (27) so that you can lift out the linkage rod (27) and the spring (26) and washer (not shown). Place the spring and new linkage rod back into the ash dump.
5. Before you replace the ash dump, reach up into the bottom and make sure the air shutter plate moves easily left to right. If you are experiencing any binding, the retaining bar above the plate may be bent in a restrictive position. This is a light metal piece that you can easily bend up to relieve this pressure.
6. With the washer, spring, and linkage properly installed (remember to tap the roll pin back into the linkage rod), lift up the ash dump (making sure the pin that extends down from the shutter plate drops into the slot in the extension on the linkage rod – as shown in the circled portion of the illustration on page one) and position it so that the bolts can be rethreaded back into the bottom to attach the ash dump back onto the bottom.
7. Line up the ash door and secure it by turning in the two screws previously removed.
8. Check the primary air control for fit and function.