

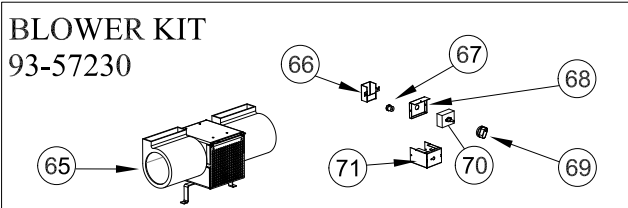

Model: Stowe 8323

Illustrated Parts List

Revision: October 28, 2015

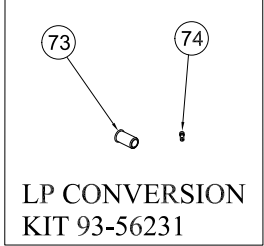
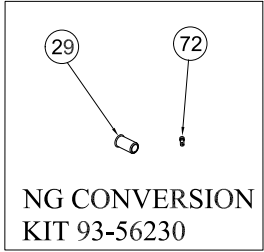
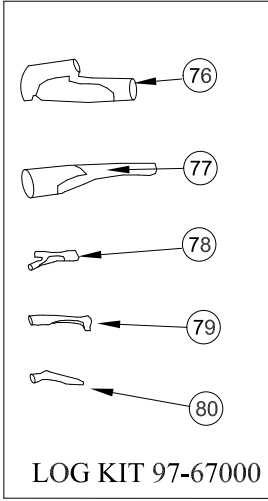
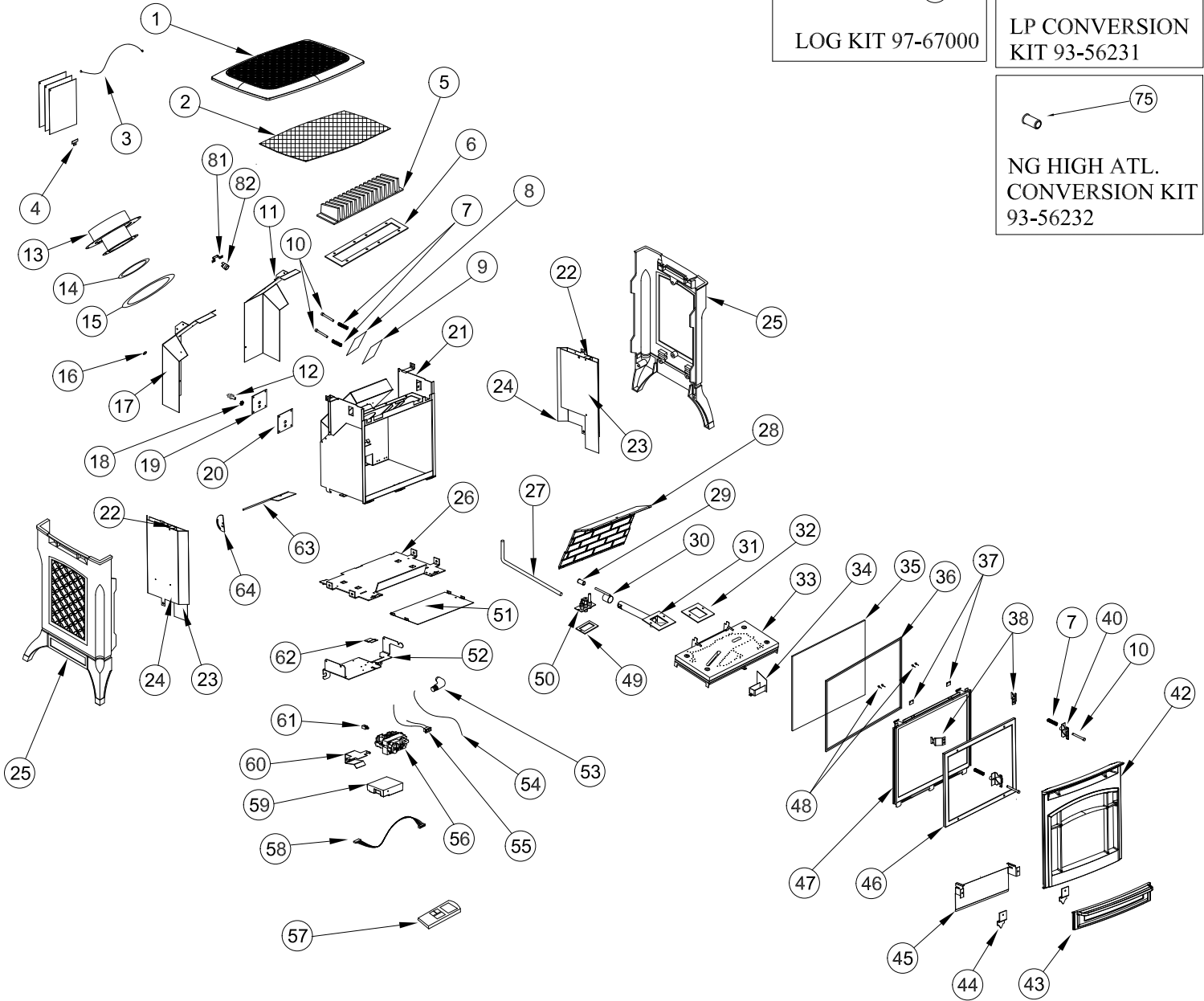



Model: Stowe Mdl.# 8323
 Production: May-15
 Serial #: 2000 -

Note: Specify color for enameled cast iron parts.

Key	Part #	Description	QTY.
1	2310-232	TOP: MATTE, STO 3	1
2	5323-235	SCREEN: TOP, STO 3, STO 4	1
3	5570-030	CABLE: LABEL, 1/16"Dx12", 2 EYES, HOM/DV	1
5	2710-487	HEAT EXCHANGER: TUC2/STO2/STO3/BRI/WAI	1
6	3160-150	GASKET: HEAT EX, 4"x14.5	1
7	5240-150	SPRING: COMPRESSION, 17-7 PH SS SPC-56234	4
8	5710-100	PLATE: DELAYED IGNITION, TUC 2/BRI/STO 2	1
9	3160-105	GASKET: DELAY IGNIT, TUC/BRI/STO/STO3/WAI	1
10	4500-1400	SCREW: CAP, 1/4-20x2-1/4", HEX, ZN, GR5	4
11	5323-274	DEFLECTOR: FAN, REAR RIGHT, STO 3	1
12	7210-007	FITTING: STRT, 3/8"NPTx3/8"CMP(NUT&FER)	1
13	5701-924HB	COLLAR: INLET/EXIT, 4"x6-5/8", STOWE/TUC	1
14	3160-155	GASKET: EXIT, 4"x6", STO/TUC DV/TRI DV/	1
15	3160-157	GASKET: INLET, 6-1/2"x9-5/16", CHA/STO/	1
16	7000-130	GROMMET: SIL. 45" PANEL X. 25" ID, M-633, EQU	1
17	5323-275	DEFLECTOR: FAN, REAR LEFT, STO 3	1
18	4200-0090	NUT: JAM, 1/8" NPT, BRASS (15-005)	1
19	5710-210	PLATE: REAR ORIFICE, TUC 2	1
20	3160-107	GASKET: REAR ORIFICE PLATE, TUC 2	1
21	5323-200	FIREBOX: STO 3	1
22	5323-032	SPACER: HEATSHIELD, SIDE, STO 3	4
23	5323-031	HEATSHIELD: SIDE, INNER, STO 3	2
24	5320-030	HEATSHIELD: SIDE, OUTER, STO	2
25	2310-331	SIDE: MATTE, STO 2	2
26	5323-025	BASE: PLATE, STO 3	1
27	7211-018	TUBE: GAS, FLEX, 3/8"x12", 321/78/05(T6-1	1
28	2310-250	BAFFLE: STO 3	1
30	7211-220	SHUTTER: AIR CONTROL, PRIMARY, STG	1
31	5710-015	VENTURI: BURNER TUBE TUC 2, STOWE 3	1
32	3160-106	GASKET: VENTURI /BURNER, TUC 2	1
33	7211-588	BURNER: EMBER, TUC 2, STO 3	1
34	5710-277	PILOT SHIELD: TUC 2	1
35	3030-060	GLASS: 12.75"x15.23"x5mm, TUC 2	1
36	3160-081	GASKET: TAPE, 3/4"x1/8", AD (1250/SPOO	5.66ft
37	5870-095	CLIP: GLASS, BLACK OXIDE, CHA/STO/DVI 32,	2
38	5323-240	BRACKET: FRONT, CORNER, TOP, STO 3	2
40	5710-279	HANDLE: SPRING HOOK, TUC 2/BRI/WAI	2
42	2310-231	FRONT: MATTE, STO 3	1
43	2310-230	DOOR: ASH LIP, MATTE, STO 3	1
44	5323-040	BRACKET: FRONT, SUPPORT, STO 3	2
45	5323-060	PANEL: MOD, ASHLIP SUPPORT, STO 3	1
46	5323-277	SCREEN: SAFETY, FRONT GLASS, STO 3	1
47	5323-230	FRAME: GLASS, STO 3	1
48	4400-0203	RIVET: BLIND, 1/8x1/8" GRIP, SS SEALED	18
49	3160-152	GASKET: PILOT, 1.75"x3"	1
50	7211-332	PILOT: NG ASS'Y, IPI, PSE (PSE-C7-542)	1
51	5323-020	HEATSHIELD: BOTTOM, STO, CHA, BRI, WAI	1

Key	Part #	Description	QTY.
52	5323-010	BRACKET: VALVE MOUNT, STO, CHA, BRI, WAI	1
53	7211-020	FITTING: 90deg,ELBOW,3/8-27Mx3/8"CMP	1
54	7000-029	WIRE: INTERRUPT, TC, MAX (G60-ZKIRS/500)	1
55	7000-028	WIRE:INTERRUPT, SW, MAX (G60-ZSKSS/500)	1
56	7211-308	VALVE:NG,MAX,TAPPED(GV60M1-B5C3GL-0032)	1
57	7000-360	REMOTE: MAX, GV60, US (G6R-H3TV4)	1
58	7000-044	WIRE HARNESS:8 WIRE, MAX, 500MM (G6R-C5)	1
59	7000-381	BOARD: GV60 RCV, MAX, (G6R-R3AU)	1
60	5323-030	BRACKET: CNTRL BOARD, STO, CHA, BRI, WAI	1
61	7000-027	INTERRUPTER: THRMCP, MAX (G60-ZUS32)	1
62	5323-015	VALVE SUPP CLIP, STO 3/CHA 2/BRI 3/WAI	1
63	5323-270	PLATE: RESTRICTOR, STO 3	1
64	5301-070	INDICATOR: RESTRICT PLATE,CHA 1/SAN 1 DV	1
81	5870-022	STRAP: T'STAT SWITCH,DVI 32/TUC 1 DV	1
82	7000-301	SWITCH: T'STAT,BLOWER,TUC 1/WIN/DVI 32	1
	97-67000	LOG SET: TUC 2, STO 2 (Contains the following):	1
		76 Not available individually	1
		77 Not available individually	1
		78 Not available individually	1
		79 Not available individually	1
		80 Not available individually	1
	93-56230	FUEL CONVERSION KIT (NG): STO 3 (8323) Contains the following:	
		29 7200-243 ORIFICE: BURNER HOOD,#43 (24-019S-43)	1
		72 7211-176 ORIFICE: VALVE, NG, ADJUSTABLE, MAXITROL	1
	93-56231	FUEL CONVERSION KIT (LP): STO 3 (8323) Contains the following:	
		73 7200-120 ORIFICE: BURNER HOOD,#55 (24-019S-55)	1
		74 7211-170 ORIFICE:VALVE,LP, #130,MAX (G30-ZEOR130)	1
	93-56232	HIGH ALTITUDE KIT (NG): STO 3 (8323) Contains the following:	
		75 7200-129 ORIFICE: BURNER HOOD,#44 (24-019S-44)	1
	93-57230	BLOWER KIT: STO 3 (8323)	
		65 7211-600 FAN: BLOWER,ASSY, TUC 2,CHA 2,STO 3	1
		66 5970-110 SHIELD: T'STAT,TUC 1 DV	1
		67 7200-114 STRAIN RELIEF: 6N3-4 (#1200)	1
		68 5950-761 COVER: RHEOSTAT BOX,BLOWER,SAN	1
		69 7200-602 KNOB: FAN CONTROL	1
		70 7200-601 CONTROL: MOTOR,AC,VARIABLE SPEED,BLOWERS	1
		71 5950-760 BOX: RHEOSTAT,BLOWER,SAN	1

