

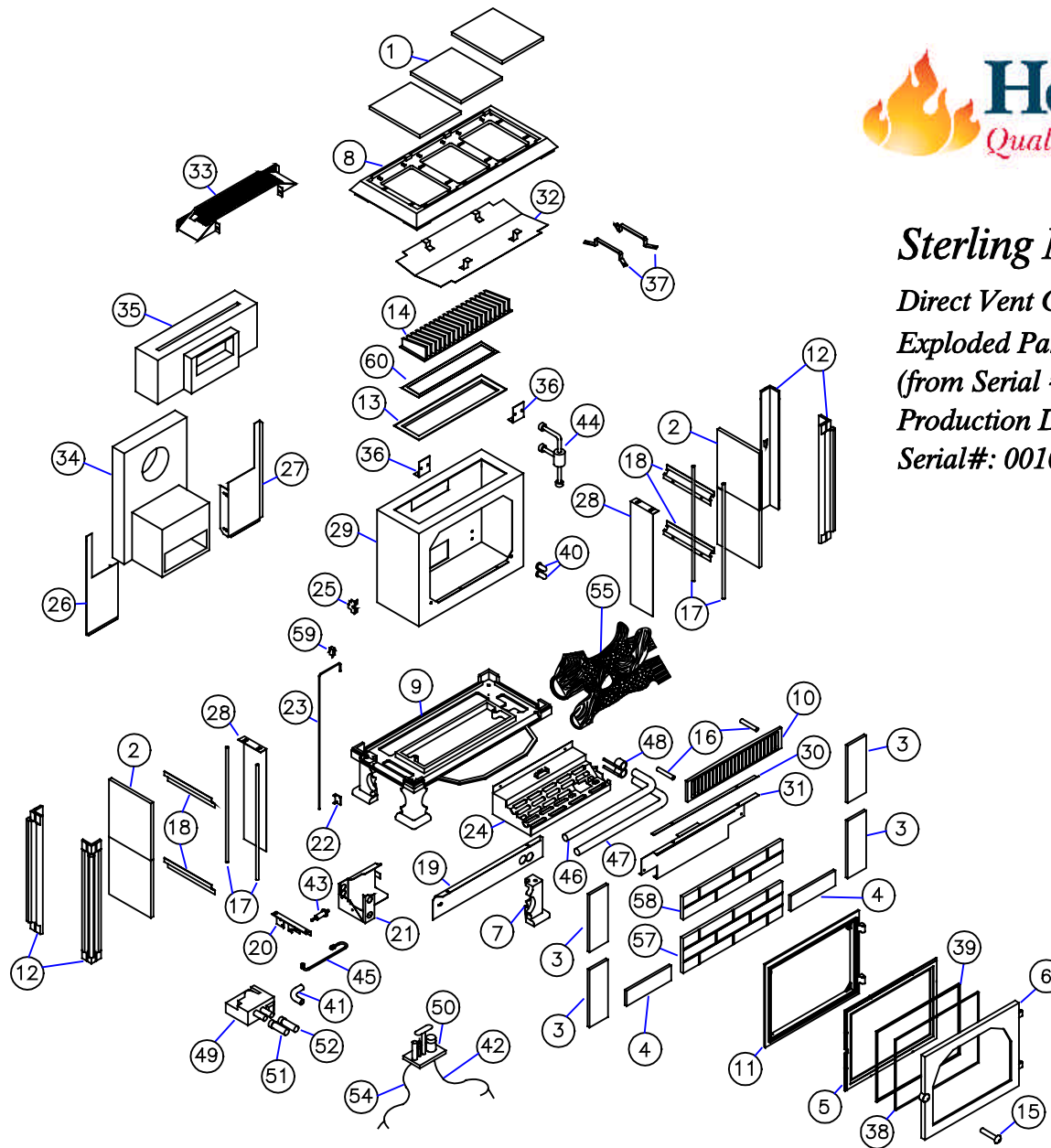

Sterling Model #8531

Direct Vent Gas Stove Heater
Exploded Parts Drawing, Revision 1.6
(from Serial #006175)
Production Dates: April 1997 -
Serial#: 001001 -





Model: Sterling Direct Vent #8531

Production Dates: April 1997 -

Serial #: 001001 -

Note: Color must be specified for cast iron parts which are available in enamel and stones in marble or granite.

Key	Part #	Description
1	1546-462	Top Stone 8" x 9 1/2" Beveled 4 sides
2	1546-462A	Side Stone 8" x 9 1/2" Beveled 2 sides
3	1546-463	Front Side Stone 3 1/2" x 9 1/2"
4	1546-464	Front Bottom Stone 2 1/2" x 8 1/2"
5	2421-316	Glass Frame
6	2510-219RS	Front Door
7	2510-303	Bottom Leg
8	2510-401	Top Casting
9	2510-402	Bottom Casting
10	2510-403A	Front Grill
11	2510-411RF	Front Door Frame
12	2510-413	Side Leg (Corner Post)
13	2510-422	Heat Exchanger Base
14	2510-423	Heat Exchanger
15	4500-2160	Front Door Screw (10-24 x 1 1/4)
16	4500-3720	8-32x1" Threaded Rod for Front Grill
17	5210-2325	Threaded Rod (3/8-16 x 22")
18	5500-2409	Stone Clip
19	5501-110	Front Façade
20	5501-115	Piezo/Valve Bracket
21	5501-120	Valve Door w/Hinge
22	5501-124	Delayed Ignition Switch Bracket
23	5501-130	Delayed Ignition Switch Rod
24	5501-150	Inlet Plenum/Log Rack
25	5501-166	Shutter Clamp
26	5501-207	Rear Cover - Left
27	5501-208	Rear Cover - Right
28	5501-480	Side Shield
29	5501-503	Firebox
30	5501-570	Ceramic Panel Bracket
31	5501-580	Fire Baffle
32	5501-586	Top Shield
33	5501-591	Rear Top Grille
34	5501-605	External Inlet Plenum
35	5501-606	External Heat Exchanger

36	5501-700	Front Grill Bracket
37	5501-702	Blast Limiters
38	94-58405	Glass Assembly
		Includes:
	3030-025	Glass 11 5/16" x 15 19/32" x 5mm
	3160-080	4 1/2' of 3/4" x 1/16" Gasket Tape
39	3160-080	4 1/2' of 3/4" x 1/16" Gasket Tape
40	7200-131	(2) #46 NG Burner Orifice
41	7210-008	90 Degree Elbow 3/8" NPT x 3/8" Compression
42	7211-430	Ceramic Electrode w/ Piezo wire
43	7210-103	Piezo Igniter
44	7211-051	Gas Manifold
45	7211-009	Pilot Gas Tube w/fittings
46	7211-202	Rear Burner
47	7211-212	Front Burner
48	7211-220	Burner Tube Air Shutter
49	7211-310	Nova S.I.T. 820 Valve w/50% Turn-Down Regulator - NG
50	7211-372	4 Way Top Convertible Pilot Assembly
		Includes:
	7211-009	Pilot Gas Tube w/fittings
	7211-470	Thermocouple 1 1/2" long body
	7210-090	Thermopile w/metal wrap
	7211-430	Ceramic Electrode w/ Piezo wire
	7211-391	4 way pilot hood
	7211-163	Pilot orifice NG .62mm
51	7211-401	Off/Pilot/On Extension Knob
52	7211-402	Low/Hi Extension Knob
54	7211-470	Thermocouple 1 1/2" long body
55	95-57210	Log Set Includes:
	7211-502	Back Log
	7211-503	Center Log
	7211-504	Front Log
	5500-2402	Ember Support Screen
	7211-558	Embers 2oz.
57	7211-510	Ceramic Rear Panel
58	7211-511	Ceramic Top Panel
59	7211-028	Delayed Ignition Safety Switch
60	3160-920	Heat Exchanger Base Gasket 19 7/8" x 7 7/8"
	3160-075	Heat Exchanger Gasket 5/8" x 1/4"
	3160-910	Inlet Gasket 9" x 6"
	3160-165	Air Shutter Gasket .5" x 2" (Not Shown)
	3160-915	Rear Gasket 9" x 15 1/8" (Not Shown)
	3300-131	Safety Rating Label
	3300-133	Fuel Conversion/Warning Label
	3300-134	Cleaning Label
	3300-210	Lighting Instruction Label

7000-032	Wire Harness for On/Off/T-Stat Switch
7000-200	3-Way Switch On/Off/T-Stat
3300-334	On/Off/T-stat Label
90-56920	Wall Thermostat Kit
	Includes:
7000-015	40' 18/2 Thermostat Wire
7200-506	Millivolt Wall Thermostat
95-56310	NG Conversion Kit Top Convertible Serial Number > 005766
	Includes:
7200-131	(2) #46 NG Burner Orifice
7211-163	.62mm NG Pilot Orifice
7211-312	NG Regulator 50% Turn Down
95-56916	NG Conversion Kit Pre-Top Convertible Serial # < 005766
	Includes:
7200-131	(2) #46 NG Burner Orifice
7211-151	.51mm NG Pilot Orifice
7211-312	NG Regulator 50% Turn Down
95-56311	LP Conversion Kit Top Convertible Serial # > 005766
	Includes:
7200-120	#55 LP Burner Orifice
7200-125	#56 LP Burner Orifice
7211-136	.35mm LP Pilot Orifice
7211-313	LP Regulator 50% Turn Down
95-56917	LP Conversion Kit Pre-Top Convertible Serial # < 005766
	Includes:
7200-120	#55 LP Burner Orifice
7200-125	#56 LP Burner Orifice
7211-135	.36mm LP Pilot Orifice
7211-313	LP Regulator 50% Turn Down
95-65010	Optional Restrictor Kit
	Includes:
5950-920	Restrictor Plate
3160-101	5" x 7" Exit Gasket
4500-0062	#10-3/8" Self Taping Pan Head Screw