

Serial#s 001001-2044 Only
Prior to Rev. 0.2



Champlain Model #8300

Direct Vent Gas Stove Heater

Exploded Parts Drawing, Revision 0.8
(from Serial #002933)

Production Dates: August 1999 -
Serial#: 001001 -

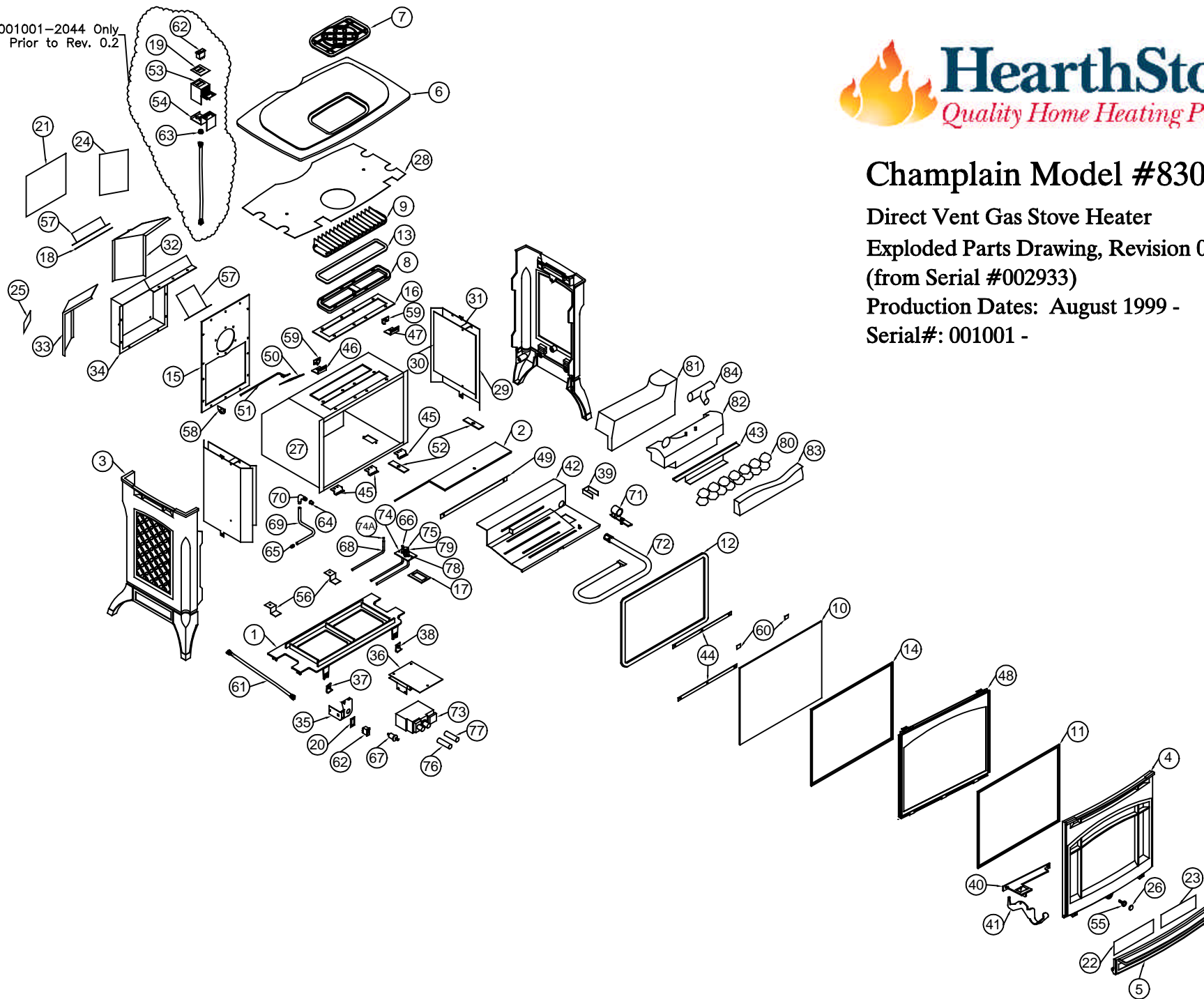



Model: Champlain #8300

[Link to Parts Price List](#)

Production Dates: August 1999 -

Serial #: 001001 -

Note: Color must be specified for cast iron parts which are available in enamel.

Key	Part #	Description
1	2310-140	Bottom Casting
2	2310-240	Firebox Baffle
3	2310-340	Side Casting
4	2310-440	Front Casting
5	2310-442	Ash Lip/Control Access Door
6	2310-840	Top Casting
7	2310-845	Top Grill
8	2310-850	Heat Exchanger Base
9	2310-860	Heat Exchanger
10	3030-015	Glass 19 1/2" x 15" x 5mm Serial # <002933
	3030-036	Glass 18 1/2" x 14 1/4" x 5mm Serial # >002933
11	3110-055	Gasket -Front 3/16" High Density x 5.2' Serial #<002933
12	3110-060	Gasket -Firebox 3/4" x 5.4' Tadpole Serial # <002933
13	3160-075	Gasket -Heat Exchanger 5/8" x 1/4" x 2.9'
14	3160-080	Gasket -Glass 3/4" x 1/16" x 3.7' (Top & Bottom Edges Only)
	3160-080	Gasket -Glass 3/4" x 1/16" x 5.7' (All 4 Sides)
15	3160-135	Gasket -Inlet/Exit 10 3/4" x 17 3/4"
16	3160-150	Gasket -Heat Exchanger Base 4" x 14 1/2"
17	3160-152	Gasket -Pilot Assembly
18	3160-157	Gasket -Inlet
19	3300-220	Label -On/Off-T-stat Serial # <002044
20	3300-224	Label -On/Off-T-stat Serial # >002044
21	3300-523	Safety Rating Label
22	3300-524	Lighting Instructions Label -Left
23	3300-525	Lighting Instructions Label -Right
24	3300-526	Installation Instructions Label
25	3300-528	Fuel Conversion Label
26	4700-0800	Ash Lip/Control Access Door Magnet

27	5300-010	Firebox Serial Number < 002933
	5300-011	Firebox Serial Number > 002933
28	5300-020	Top Heatshield
29	5300-030	Outer Side Heatshield
30	5300-031	Inner Side Heatshield
31	5300-032	Side Heatshield Spacer
32	5300-040	Left Rear Heatshield
33	5300-050	Right Rear Heatshield
34	5300-060	Air Intake
35	5300-066	Bracket for Piezo Igniter & On/Off/T-stat Switch
36	5300-080	Valve Shield Bracket
37	5300-082	Front Left Clip
38	5300-084	Front Right Clip
39	5300-085	Pilot Shield
40	5300-086	Front Latch Mount E-Z Off Front
41	5300-088	Front Latch Arm E-Z Off Front
42	5300-090	Secondary Air Plenum
43	5300-095	Ember Screen
44	5300-100	Glass Clip Serial # <002933
45	5300-102	Bottom Glass Clip Serial #>002933
46	5300-104	Left Top Glass Clip Serial # >002933
47	5300-106	Right Top Glass Clip Serial # >002933
48	5300-108	Glass Frame
49	5300-110	Baffle Clip
50	5300-112	Restrictor Plate Serial # >002807
51	5300-114	Restrictor Plate Rod Serial # >002807
52	5300-118	Blast Limiter
53	5300-120	On/Off/T-stat Switch Housing Serial # <002044
54	5300-130	On/Off/T-stat Switch Mounting Bracket Serial # <002044
55	5300-010	Magnet Mount
56	5320-085	Firebox Clip
57	5701-925H	Starter Collar 4" I.D.
58	5800-210	Restrictor Setting Plate Serial # >002807
59	5870-092	Glass Frame Retainer Clip E-Z Off Serial # >002933
60	5870-095	Glass Clip Serial # >002933
61	7000-031	Wire Harness On/Off/T-Stat
62	7000-200	3-Way Switch On/Off/T-Stat
63	7200-113	Strain Relief Serial # <002044
64	7200-231	Burner Orifice NG #31
65	7210-007	3/8" NPT x 3/8" Compression Straight Fitting
66	7210-090	Thermopile Metal Wrapped

67	7210-103	Piezo Igniter
68	7211-009	Pilot Gas Tube
69	7211-017	Gas Manifold 3/8" x 18" Flex Tube from Valve to Orifice
70	7211-020	1/8" NPT x 3/8" Compression 90 degree Elbow
71	7211-231	Air Shutter Control Serial # >002775
72	7211-247	Burner Tube Serial # >002775
	7211-245	Burner Tube Serial # <002775
73	7211-310	S.I.T. Nova 820 Valve NG w/50% Turn Down Regulator
74	7211-370	Pilot Assembly 3-Way
		Includes:
	7211-009	Pilot Gas Tube
	7211-470	Thermocouple
	7210-090	Thermopile Metal Wrapped
	7211-430	Ceramic Electrode w/Piezo Wire
	7211-390	Pilot Hood 3-Way
	7211-163	Pilot Orifice .62mm NG w/threads (Not Shown)
75	7211-390	Pilot Hood 3-Way
76	7211-401	Valve Knob Extension On/Off/Pilot
77	7211-402	Valve Knob Extension Hi/Low
78	7211-430	Ceramic Electrode w/Piezo Wire
79	7211-470	Thermocouple
	93-57210	Log Set
		Includes:
80	7211-558	Embers 2 oz. Bag
81	7211-530	Rear Log
82	7211-531	Middle Log
83	7211-532	Front Log
84	7211-533	Top Log
	90-56920	Wall Thermostat Kit
		Includes:
	7000-015	40' 18/2 Thermostat Wire
	7200-506	Millivolt Wall Thermostat
	97-56600	NG Conversion Kit 50% Turn Down, Top Convertible
		Includes:
	7200-231	#31 NG Burner Orifice
	7211-163	.62mm NG Pilot Orifice w/threads
	7211-312	NG Regulator 50% Turn Down

93-56900 NG Conversion Kit 50% Turn Down, Pre-Top Convertible

Includes:

- 7200-231 #31 NG Burner Orifice
- 7211-151 .57mm NG Pilot Orifice (Drop In)
- 7211-312 NG Regulator 50% Turn Down

93-56901 LP Conversion Kit 50% Turn Down, Pre-Top Convertible

Includes:

- 7200-249 #49 LP Burner Orifice
- 7211-130 .30mm LP Pilot Orifice (Drop In)
- 7211-313 LP Regulator 50% Turn Down

93-65010 Vent Restrictor Kit Serial # <002807

Includes:

- 3160-155 Gasket 4" x 6" Exit
- 4500-0062 #10x 3/8" Self Taping Pan Head Screw
- 5950-916 Restrictor Plate