

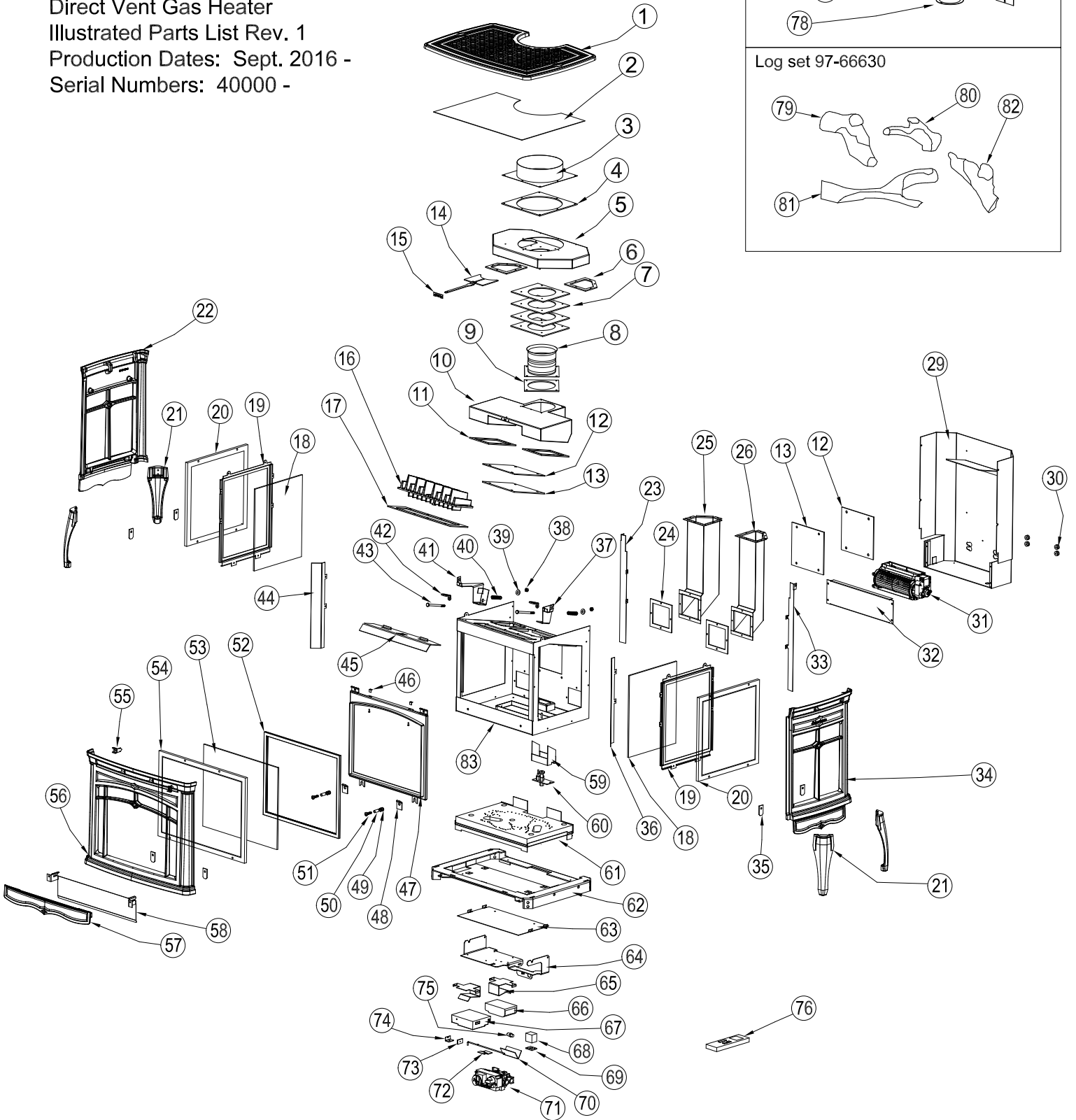

Bristol DX Model # 8763
Direct Vent Gas Heater
Illustrated Parts List Rev. 1
Production Dates: Sept. 2016 -
Serial Numbers: 40000 -



LP Conversion Kit 97-56631
NG Conversion Kit 97-56630

Vertical Vent Kit 97-64630



Log set 97-66630

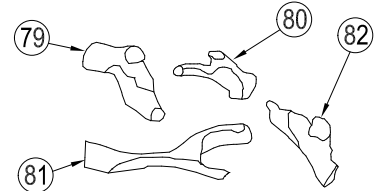



Model: Bristol #8763

Production: Sept. 2016 -

Serial #: 40000 -

Note: Specify color for enameled cast iron parts.

Key	Part #	Description	QTY.
1	2710-740	TOP: MATTE, BRI	1 EA
2	5710-383	SCREEN: TOP, BRI	1 EA
3	5701-926	COLLAR: INLET,6-5/8", BRI / WAI	1 EA
4	3160-225	GASKET: FLUE INLET, BRI / WAI	1 EA
5	5763-355	INLET COLLECTOR: BRI 3	1 EA
6	3160-722	GASKET: AIR INLET PLENUM, BRI 3	2 EA
7	3160-210	GASKET:EXHAUST COLLAR, BRI / WAI	4 EA
8	5701-927	COLLAR: EXHAUST,4", BRI / WAI	1 EA
9	3160-228	GASKET: FLUE EXIT, BRI / WAI	1 EA
10	5763-325	EXHAUST COLLECTOR: BRI 3	1 EA
11	3160-200	GASKET: EXHAUST MANIFOLD, BRI/BRI3/WAI	2 EA
12	5763-315	PLATE: DELAYED IGNITION, 6.5" SQ, BRI 3	2 EA
13	3160-710	GASKET: DELAYED IGNIT RELIEF, BRI 3, LG	2 EA
14	5710-311	RESTRICTOR PLATE: BRI / WAI	1 EA
15	5710-395	CLIP: RESTRICTOR PACKING, BRI / WAI	1 EA
16	2710-665	HEAT EXCHANGER: BRI 3	1 EA
17	3160-712	GASKET: HEAT EXCH, BRI 3, 4.0" x 14.5"	1 EA
18	3030-065	GLASS: 9.750" x 12.500", BRI 3	2 EA
19	5763-340	FRAME: SIDE GLASS, BRI 3	2 EA
20	5763-035	SCREEN: SAFETY, SIDE GLASS, BRI 3	2 EA
21	2710-700	FOOT: MATTE, BRI/BRI3/WAI	4 EA
22	2710-720	SIDE: LEFT MATTE, BRI 3	1 EA
23	5763-215	CORNER SHIELD, REAR, LEFT, BRI 3	1 EA
24	3160-706	GASKET: INLET COLLAR PLATE, BRI 3	2 EA
25	5763-335	CHANNEL: PRIMARY AIR, LEFT, BRI 3	1 EA
26	5763-330	CHANNEL: PRIMARY AIR, RIGHT, BRI 3	1 EA
29	5763-350	DEFLECTOR: CONVECT AIR, BRI 3	1 EA
30	7000-130	GROMMET:SIL.45"PANELX.25"ID,M-633,EQU	4 EA
31	7211-944	FAN: BLOWER,ASSY,LEFT,CLY/BRI #J2388224	1 EA
32	5710-347	SCREEN: BLOWER, BRI / WAI	1 EA
33	5763-210	CORNER SHIELD, REAR, RIGHT, BRI 3	1 EA
34	2710-725	SIDE: RIGHT, MATTE, BRI 3	1 EA
35	5710-250	BRACKET: LOWER MOUNT, TUC 2/BRI/WAI	6 EA
36	5763-220	CORNER SHIELD, FRONT, RIGHT, BRI 3	1 EA
37	5763-365	BRACKET: TOP CORNER MOUNT, RIGHT, BRI 3	1 EA
38	4200-0310	NUT: LOCK,1/4-20,STOVER,HEX,ZN	10 EA
39	4600-0300	WASHER: FLAT,1/4,USS,BLK OX (3/4" OD)	8 EA
40	5240-150	SPRING: COMPRESSION,17-7 PH SS SPC-56234	6 EA
41	5763-360	BRACKET: TOP CORNER MOUNT, LEFT, BRI 3	1 EA
42	5763-343	HANDLE: SPRING PULL, BRI 3	2 EA
43	4500-1695	SCREW: 1/4-20x3-1/2", HHCS BLK OX	2 EA
44	5763-225	CORNER SHIELD, FRONT, LEFT, BRI 3	1 EA
45	5763-320	BAFFLE: BRI 3	1 EA
46	5710-365	CLIP: FRONT GLASS,BLK OX, BRI/DVI 38/44	2 EA
47	5763-345	FRAME: FRONT GLASS, BRI 3	1 EA

Key	Part #	Description	QTY.	p.2
48	5710-390	CLIP:FRONT GLASS MOUNT,BLK OXIDE,BRI/WAI	2 EA	
49	5000-108	SPRING:.48"ODx .5", 17-7SST, SPC 56268	6 EA	
50	5710-405	SLEEVE: .335"ODx.260"IDx .75"	2 EA	
51	4500-1040	SCREW: BHCS,1/4-20x1", BL OX	2 EA	
52	3160-060	GSKT: TAPE,1/4BDx5/8FLX7/8OA TADPOLE180'	5 FT	
53	3030-063	GLASS: 15.125" x 12.500", BRI 3	1 EA	
54	5763-040	SCREEN: SAFETY, FRONT GLASS, BRI 3	1 EA	
55	5710-375	BRACKET: FRNT MOUNT,BLACK OXIDE,BRI/WAI	2 EA	
56	2710-730	FRONT: MATTE, BRI 3	1 EA	
57	2710-710	DOOR: CONTROL MATTE, BRI 3	1 EA	
58	5763-080	PANEL: CONTROL MODESTY, MAX, BRI 3	1 EA	
59	5710-307	SHIELD: PILOT, BRI / WAI	1 EA	
60	7211-332	PILOT: NG ASS'Y, IPI, PSE (PSE-C7-542)	1 EA	
61	7211-634	BURNER, COMPLETE, BRI 3	1 EA	
62	5763-100	BASE PLATE: BRI 3	1 EA	
63	5323-020	HEATSHIELD: BOTTOM, STO, CHA, BRI, WAI	1 EA	
64	5323-010	BRACKET: VALVE MOUNT, STO, CHA, BRI, WAI	1 EA	
65	5323-030	BRACKET: CNTRL BOARD, STO, CHA, BRI, WAI	2 EA	
66	7000-382	BOARD: FAN CONTROL, MAX, (G6R-BUMV2)	1 EA	
67	7000-381	BOARD: GV60 RCV, MAX, (G6R-R3AU)	1 EA	
68	7211-060	MANIFOLD: GAS, BRI 3	1 EA	
69	3160-762	GASKET: ORIFICE BLOCK, BRI 3	1 EA	
70	5770-215	AIR SHUTTER ASSY: BRI3, WAI	1 EA	
71	7211-308	VALVE:NG,MAX,TAPPED(GV60M1-B5C3GL-0032)	1 EA	
72	5323-015	VALVE SUPP CLIP, STO 3/CHA 2/BRI 3/WAI	1 EA	
73	3160-763	GASKET: AIR SHUTTER LOCK, BRI 3	1 EA	
74	5763-110	BRACKET: AIR SHUTTER LOCK, BRI 3	1 EA	
75	7200-441	ORIFICE: HOOD,MALE THREADS,#41	1 EA	
76	7000-360	REMOTE: MAX, GV60, US (G6R-H3TV4)	1 EA	
77	5763-310	PLATE: RESTRICTOR,HI VENT, BRI 3	2 EA	
78	5763-370	RING: RESTRICTOR,HI VENT, BRI 3	1 EA	
79	7211-635	LOG: CERAMIC, REAR LEFT, BRI 3	1 EA	
80	7211-636	LOG: CERAMIC, REAR RIGHT, BRI 3	1 EA	
81	7211-637	LOG: CERAMIC, FRONT LEFT, BRI 3	1 EA	
82	7211-638	LOG: CERAMIC, FRONT RIGHT,BRI 3	1 EA	
83	5763-300	FIREBOX: BRI 3	1 EA	