

Heritage II Model # 8022
 Wood Stove Heater
 Exploded Parts Drawing, Rev 0
 Begin Serial # 35,000 -
 Production May20, 2014

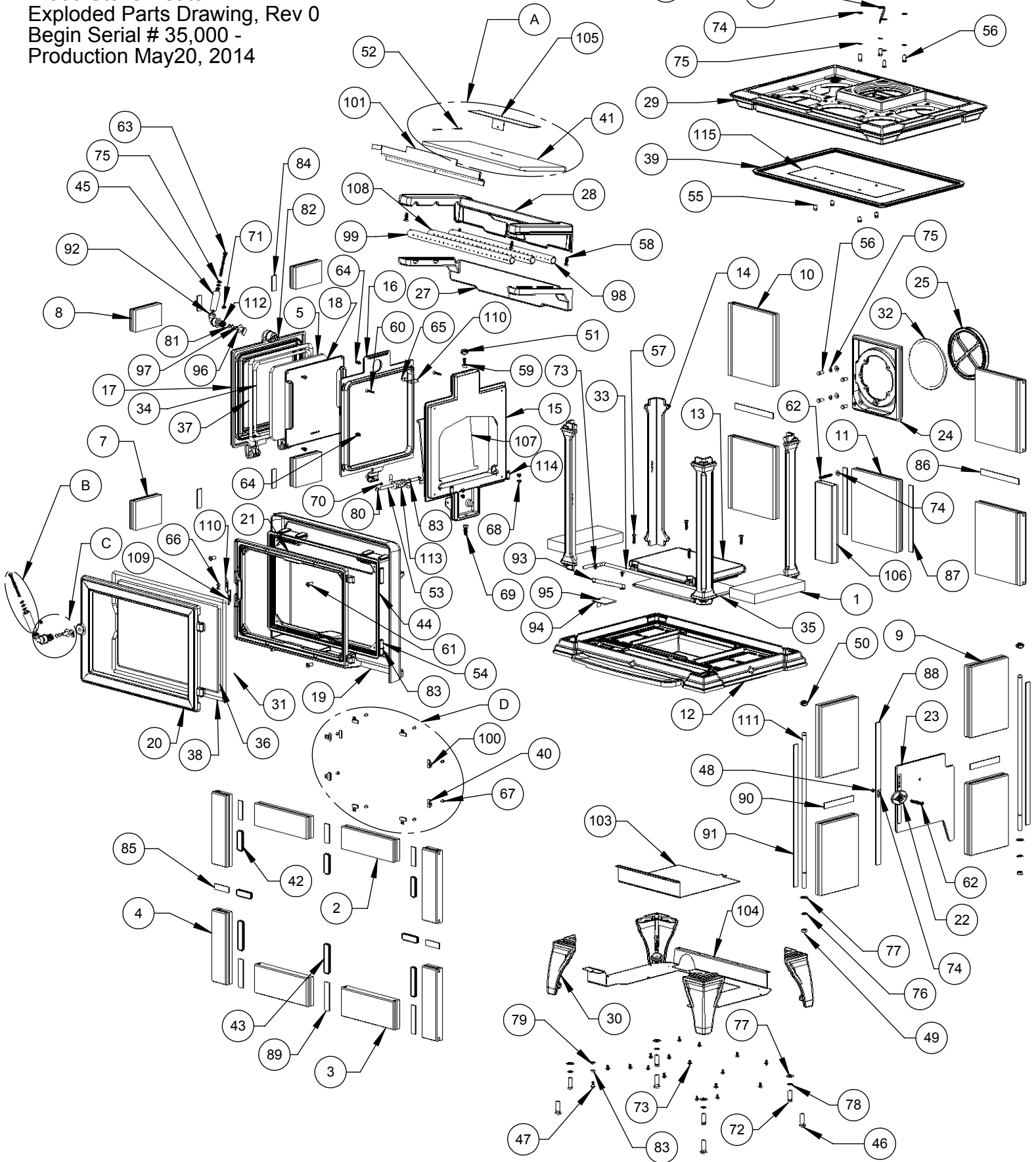

ITEM NO.	PART NUMBER	DESCRIPTION	QTY.
1	1-0000-101	STONE: REF,9.00x4.50	2
2	1141-251	STONE: POL,9.49x2.88	2
3	1141-252	STONE: POL,9.49x3.78	2
4	1141-253	STONE: POL,2-19/32"x9-1/2"	4
5	1141-270	STONE:POL,9.70x9.96X11mm,HER8022	1
6	1141-272	STONE: POL,8.02x7.85,TS	5
7	1141-276	STONE: POL,4.69x3.78	2
8	1141-278	STONE: POL,4.69x2.88	2
9	1141-280	STONE: POL,9.49x6.69	4
10	1201-25	STONE: POL,9.49x8.07	4
11	1201-26	STONE: POL,9.49x8.03	1
12	2010-211	BOTTOM CASTING	1
13	2010-221	ASH GRATE BLANK PLATE	1
14	2010-231	SIDE LEG	4
15	2010-233	SIDE DOOR FRAME	1
16	2010-235	SIDE DOOR FRAME COVER	1
17	2010-237	SIDE DOOR	1
18	2010-239	SIDE DOOR STONE PLATE	1
19	2010-247	PLENUM: PRIMARY AIR	1
20	2010-261	FRONT DOOR, MATTE	1
21	2010-263	FRONT DOOR FRAME	1
22	2010-271	SIDE TRIM, MATTE	1
23	2010-273	SIDE IMPACT PLATE	1
24	2010-280	REAR EXIT FRAME	1
25	2010-282	FLUE BLANK PLATE	1
26	2010-285	FLUE COLLAR	1
27	2010-287	SECONDARY AIR PLENUM BOTTOM	1
28	2010-289	SECONDARY AIR PLENUM TOP	1
29	2010-291	TOP CASTING, HER8022	1
30	2010-310	FOOT	4
31	3030-038	GLASS: IR,11-5/16"x18"x5mm,HER 1	1
32	3110-056 x 1.8'	GASKET, 1/4" DIA SECTION	2
33	3110-056 x 2.3'	GASKET: ROPE,3/8",BLK,AD	1

ITEM NO.	PART NUMBER	DESCRIPTION	QTY.
34	3110-056 x 3.1'	SIDE DOOR STONE GASKET, 1/4" DIAMETER CORELESS	1
35	3110-056 x 3.2'	GASKET: ROPE,1/4",BLK,AD	1
36	3110-056 x 6'	FRONT DOOR GLASS GASKET	1
37	3110-057 x 3.5'	SIDE DOOR GASKET, 3/8" DIA CORELESS	1
38	3110-057 x 6.5'	FRONT DOOR SEAL GASKET	1
39	3110-069 x 6.4'	GASKET:ROPE,TADPOLE,1"	1
40	3120-021	GASKET: GLASS CLIP,BLACK	8
41	3120-022	BOARD: CERAMIC,BAFFLE	1
42	3160-080 x 5.4in	GASKET TAPE: 3/4 x 1/16 WOVEN	5
43	3160-080 x 7.9in	GASKET TAPE: 3/4 x 1/16 WOVEN	3
44	3160-392 x 5.5'	GASKET, 3/8 x 1/8, W / ADHESIVE	1
45	3900-177	WOOD HANDLE	2
46	4100-0127	BOLT: CARRIAGE,3/8-16x1-1/2	4
47	4100-0230	SCREW: SHOULDER,10-24x1/4"Dx1/4"L,SOCKET	1
48	4200-0250	NUT: FINISHING,1/4-20,HEX,SS	1
49	4200-0400	NUT: 3/8-16,ZN,GR2,90473A031	2
50	4200-0410	NUT: TAMPER-RESISTANT,3/8-16,ZN,90080A260	2
51	4200-0415	NUT: TAMPER-RESIST,5/16-18,ZN	1
52	4300-0110	PIN: COTTER, 1/8X2",SS	2
53	4300-0182	PIN: HINGE, SIDE DOOR, HER 8022	1
54	4300-0702	PIN: CLEVIS,1/4x2",WITH CLIP	2
55	4500-0570	SCREW: CAP,1/4-20x1/2",HEX,SS	4
56	4500-0710	SCREW: CAP,1/4-20x3/4",HEX,SS	8
57	4500-0910	SCREW: CAP,1/4-20x1",HEX,SS	4
58	4500-1010	SCREW: MACH,1/4-20x1",FLAT,PH,BL OX	4
59	4500-1035	SCREW:SHCS,5/16-18X7/8",BI OX	1
60	4500-1300	SCREW: MACH,1/4-20x1-1/4",FLAT,PH,BLK OX	4
61	4500-1359	SCREW: MACH,1/4-20x3/4",PAN,PH,BLK	4
62	4500-1419	SCREW: CAP,1/4-20x2",LOW PRO,SOCK	2
63	4500-1680	Screw: Mach 1/4-20, 3-1/2, Round, Slot, Zn	2
64	4500-1876	SCREW: MACH,10-24x1/2",PAN,PH,BLK OX	4
65	4500-1910	SCREW: MACH,10-24x1/2",FLAT,PH,	2

ITEM NO.	PART NUMBER	DESCRIPTION	QTY.
66	4500-1910	SCREW: MACH,10-24x3/8",FLAT,PH,	2
67	4500-2105	SCREW: MACH,10-24x3/8",UN-CUT,FLAT,PH,	8
68	4500-2114	SCREW: MACH,10-24x3/8",PAN,PH,BLK OX	4
69	4500-2810	SCREW: CAP,3/8-16X1",HEX,ZN,GR8,92620A624	1
70	4500-2975	SCREW: SET,5/16-18x1/4",CUP POINT,SOCK	1
71	4500-2976	SCREW: SET,5/16-18x3/8",HALF DOG,SOCKET	2
72	4500-3220	SCREW: CAP,5/16-18x1-1/4",HEX,ZN,GR5	4
73	4500-3436	SCREW: T-CUT,10-24x3/8,"F",PAN,PH,BLK	18
74	4600-0310	WASHER: FLAT,1/4,SAE,ZN (5/8" OD)	8
75	4600-0400	WASHER: LOCK, 1/4",SPLIT,ZN	14
76	4600-0700	WASHER: LOCK,3/8,SPLIT,BL OX	2
77	4600-0800	WASHER: FLAT,5/16,USS (7/8" OD),BLK ZN	6
78	4600-0850	WASHER: LOCK,5/16,SPLIT,MED,ZN	4
79	4600-1415	WASHER: BELLVILLE SPRING,1/4IDx5/8OD,9712K21	1
80	4700-0600	PLUG: FINISHING,1/4" IDx13/32" OD,BLK	2
81	4700-0790	SPACER: DOOR LATCH,0.435"x0.375"x0.03"	4
82	4700-0796	SPACER: DOOR LATCH,0.435"x0.375"x0.22", TEMP TO Sn 35,320	1
83	4700-0850	SPACER: DOOR,1/4" IDx1/2" ODx1/8" T,	3
84	5000-001A	SPLINE: 2x3/4x1/8	2
85	5000-002	SPLINE: 2-1/2x3/4x1/8	7
86	5000-008	SPLINE: 6-7/8x3/4x1/8	6
87	5000-011	SPLINE: 8-3/4x3/4x1/8	2
88	5000-029	SPLINE: 18-3/4x3/4x1/8 SLOTTED	1
89	5000-2236A	SPLINE: 3-3/4x3/4x1/8	3
90	5000-2236B	SPLINE: 5-1/4x3/4x1/8	2
91	5000-2236C	SPLINE: 18-3/4x3/4x1/8	2
92	5010-081	LATCH CRANK	2
93	5021-020	PRIMARY AIR SLIDER RETAINER	1
94	5021-025-1	AIR CONTROL SLIDER	1
95	5021-025-2	AIR CONTROL PIN	1
96	5021-026	LATCH: DOOR,DOUBLE BEVEL	2

ITEM NO.	PART NUMBER	DESCRIPTION	QTY.
97	5021-032	WASHER: FLAT,.406"IDx1"ODx.035"T,BLK	2
98	5021-041	PIPE: AIR,SECONDARY,#1,HER 1	1
99	5021-043	PIPE: AIR,SECONDARY,#3,HER 1	1
100	5021-060	GLASS CLIP	8
101	5021-065	SUPPORT: BAFFLE,SS,HER	1
102	5021-070	BRUSH STOPPER	1
103	5022-010	CENTER BOTTOM SHIELD	1
104	5022-012	OUTSIDE AIR PLENUM	1
105	5022-014	BAFFLE BRACKET FOR SLOT	1
106	5022-016	SECONDARY RISER PIPE	1
107	5022-018	SIDE DOOR STOP PLATE	1
108	5022-022	SECONDARY AIR TUBE #2	1
109	5022-070	RIGHT STRIKER	1
110	5030-060	STRIKER	2
111	5210-2330	ROD: THREAD,3/8-16x20.5",0.31"&2"	2
112	5240-138	SPRING: LATCH,WOOD STOVES,325#	2
113	5240-143	SPRING: TORSION,SIDE DOOR	1
114	5350-032	CLIP: HINGE,SIDE DOOR	2
115	5570-150	HEATSHIELD: TOP,SS,HOM/HER 1	1