



# Bennington Model #8350

Wood Stove Heater

Exploded Parts Drawing, Revision 0.3  
(from Serial #001769)

Production Dates: August 2001 -  
Serial#: 001001 -

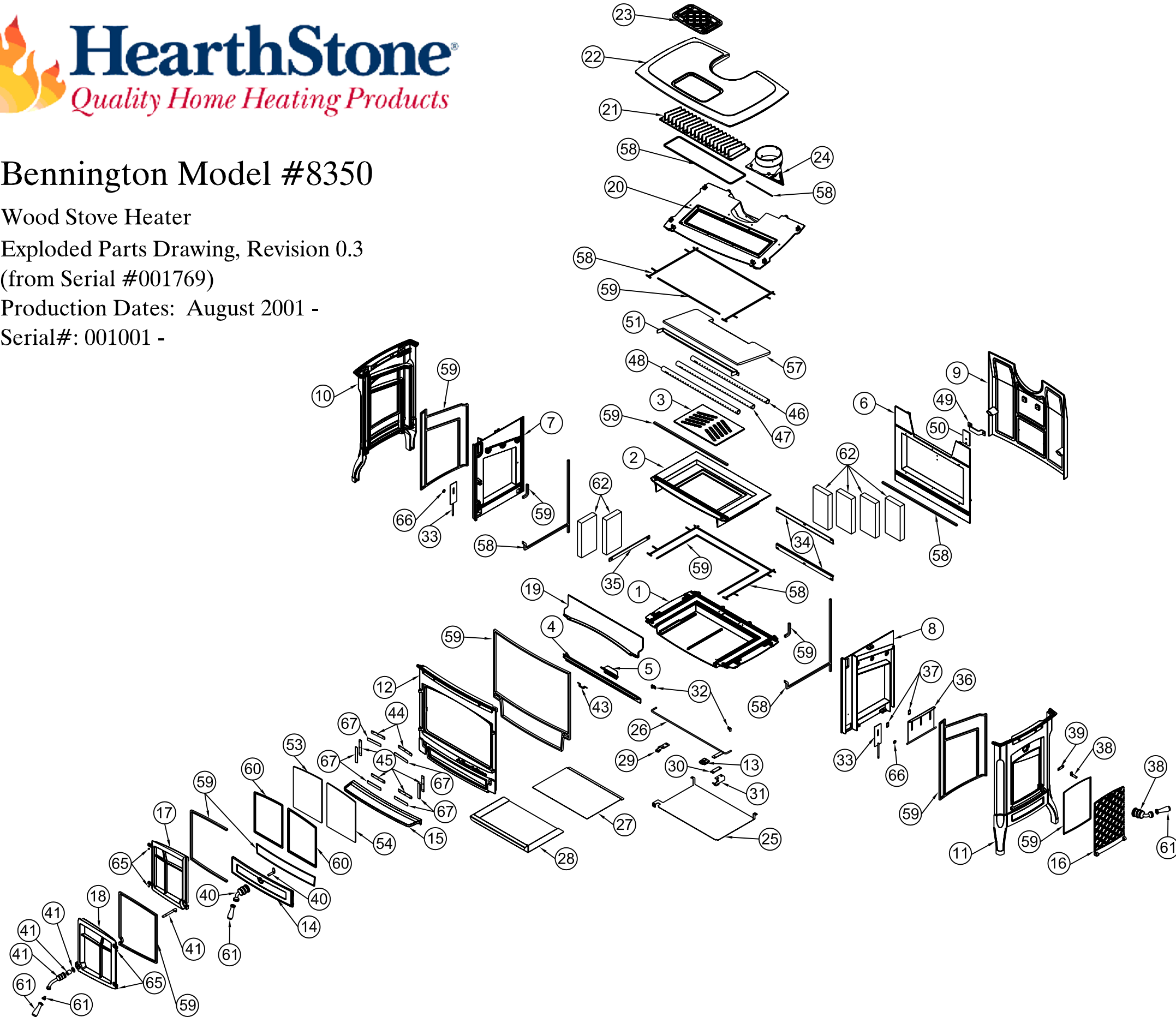



Model: Bennington #8350  
 Production Dates: August 2001 -  
 Serial #: 001001 -

[Link to  
Parts Pricelist](#)

Note: Color must be specified for cast iron parts which are available in enamel.

Key	Part #	Description
1	2310-500	Bottom Casting
2	2310-505	Ash Grate Frame
3	2310-510	Ash Grate
4	2310-512	Lower Primary Air Base
5	2310-514	Lower Primary Air Opening
6	2310-515	Back Inner Panel
7	2310-520	Left Side Inner Panel
8	2310-525	Right Side Inner Panel
9	2310-530	Back Outer Panel
10	2310-535	Left Side Outer Panel
11	2310-540	Right Side Outer Panel
12	2310-545	Front Outer Panel/Door Frame
13	2310-548	Primary Air Control Handle
14	2310-550	Ash Door
15	2310-560	Ash Lip
16	2310-565	Right Side Door
17	2310-570	Left Front Door
18	2310-575	Right Front Door
19	2310-578	Airwash Plate
20	2310-581	Firebox Top
21	2310-581	Heat Exchanger
22	2310-585	Outer Top Casting
23	2310-590	Top Grill (Trivet)
24	2310-586	Flue Collar
25	5350-005	Bottom Heatshield
26	5350-007	Primary Air Control Link
27	5350-008	Ash Bay Liner
28	5350-010	Ash Pan
29	5350-012	Ash Door Hinge Left
30	5350-013	Primary Air Control Dampener Clip
31	5350-014	Ash Door Hinge Right
32	5350-017	Primary Air Control Connector Clip
33	5350-018	Primary Air Control Slider
34	5350-020	Rear Firebrick Retainers
35	5350-025	Side Firebrick Retainer
36	5350-030	Side Door Hinge
37	5350-032	Side Door Hinge Clip

38	<b>93-73508</b>	<b>Side Door Latch Assembly</b> Includes: (2) Set Screw (4) Spacer Handle Crank Wave Spring Side Door Latch
39	5350-038	Side Door Catch
<b>40</b>	<b>93-73506</b>	<b>Ash Pan Door Latch Assembly</b> Includes: (2) Set Screw (4) Spacer Handle Crank Wave Spring Ash Pan Door Latch
<b>41</b>	<b>93-73501</b>	<b>Front Door Latch Assembly</b> Includes: (2) Set Screw (4) Spacer Front Door Latch Wave Spring Front Door Crank
43	5350-062	Front Door Striker
44	5350-050	Glass Clip: Top
45	5350-052	Glass Clip: Bottom & Side
46	5350-071	Secondary Air Tube #1
47	5350-072	Secondary Air Tube #2
48	5350-073	Secondary Air Tube #3
49	5350-076	Back Mounting Clip
50	5350-078	Back Inner Panel Mounting Clip
51	5350-080	Stainless Steel Baffle Support
<b>53</b>	<b>93-58505</b>	<b>Left Door Glass Kit</b> Includes: Left Door Glass (3' 4") Gasket: Rope 3/16" Low Density Adhesive Backed (3) Gasket: Glass Clip Gasket Glue
54	<b>93-58507</b>	<b>Right Door Glass Kit</b> Includes: Right Door Glass (3' 4") Gasket: Rope 3/16" Low Density Adhesive Backed (3) Gasket: Glass Clip Gasket Glue
57	3120-352	Ceramic Baffle Board (used on ser# after 003097)
	3120-350	Ceramic Baffle Board (used on ser# before 003096)
58	3110-056	Gasket: Rope 1/4"
59	3110-057	Gasket: Rope 3/8"
60	3160-080	Gasket: Rope 3/16" Low Density

61	<b>93-71500</b>	<b>Front Handle Kit</b> Includes: Wood Handle Screw 1/4-20x2 3/4", Rd, HD 1/4" Lock washers Handle Adapter
62	3060-426	Firebrick 4 1/2 "x 9" x 1 1/2"
65	4700-0825	Door Spacer (matte stoves only)
	4700-0815	Door Spacer (enamel stoves only)
66	5012-066	Primary Air Shutter Bushing
67	<b>93-58500</b>	<b>Gasket Kit</b> (7') Gasket: Rope 3/16" Low Density Adhesive Backed (13 1/2') Gasket: Rope 3/8" Adhesive Backed (6) Gasket: Glass Clip (1) Gasket Glue